

slate

MEDIA TECHNOLOGY

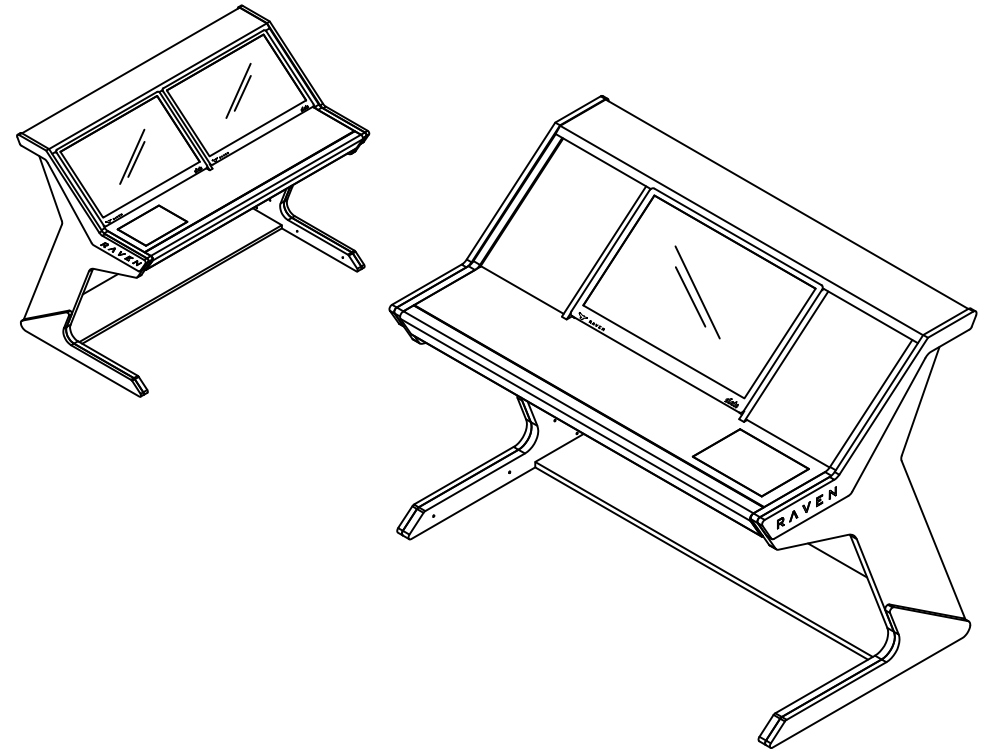

Core Station

Assembly Manual

For reasons of safety and stability, parts number 1 and 2 are assembled during transport. Before you start building your Core Station, split the pieces. You will see 4 wooden dowels which hold together the two parts.

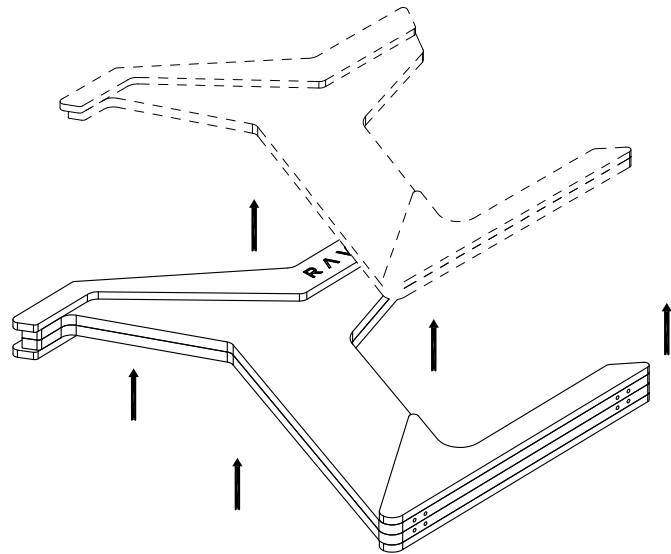

Remove the Wooden dowels and **do not use them for assembly.** You are now ready to start building your Core Station.

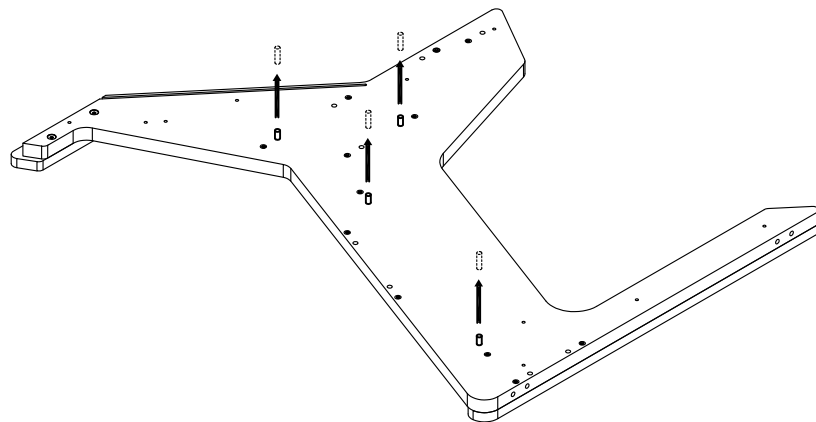

MATERIAL USED:

- MDF;
- Particle board;
- Metal Hardware.

PACKING LIST:

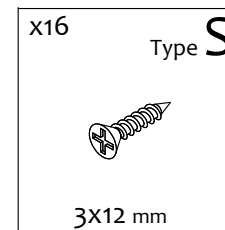
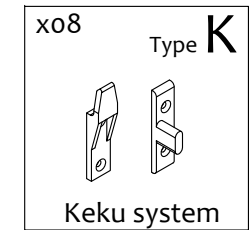
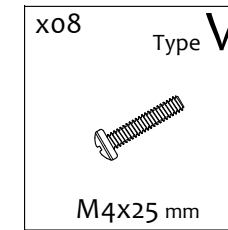
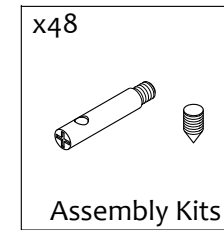
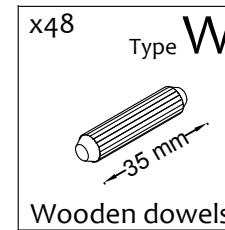

TOOLS:

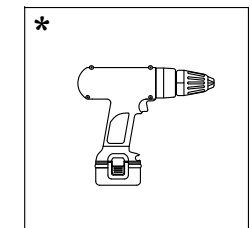
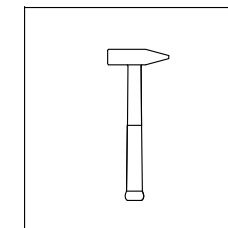
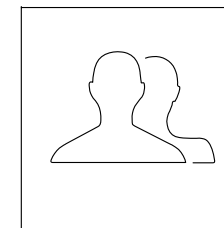
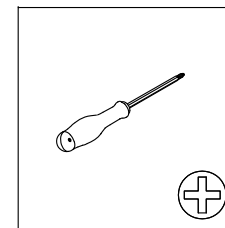

*Suggested

INSTRUCTION FOR USE AND CLEANING

- clean with a soft cloth, slightly humid or specific products for wood or lacquer;
- avoid the use of abrasive cleaners.

Step 9

Version B (2 MTis)

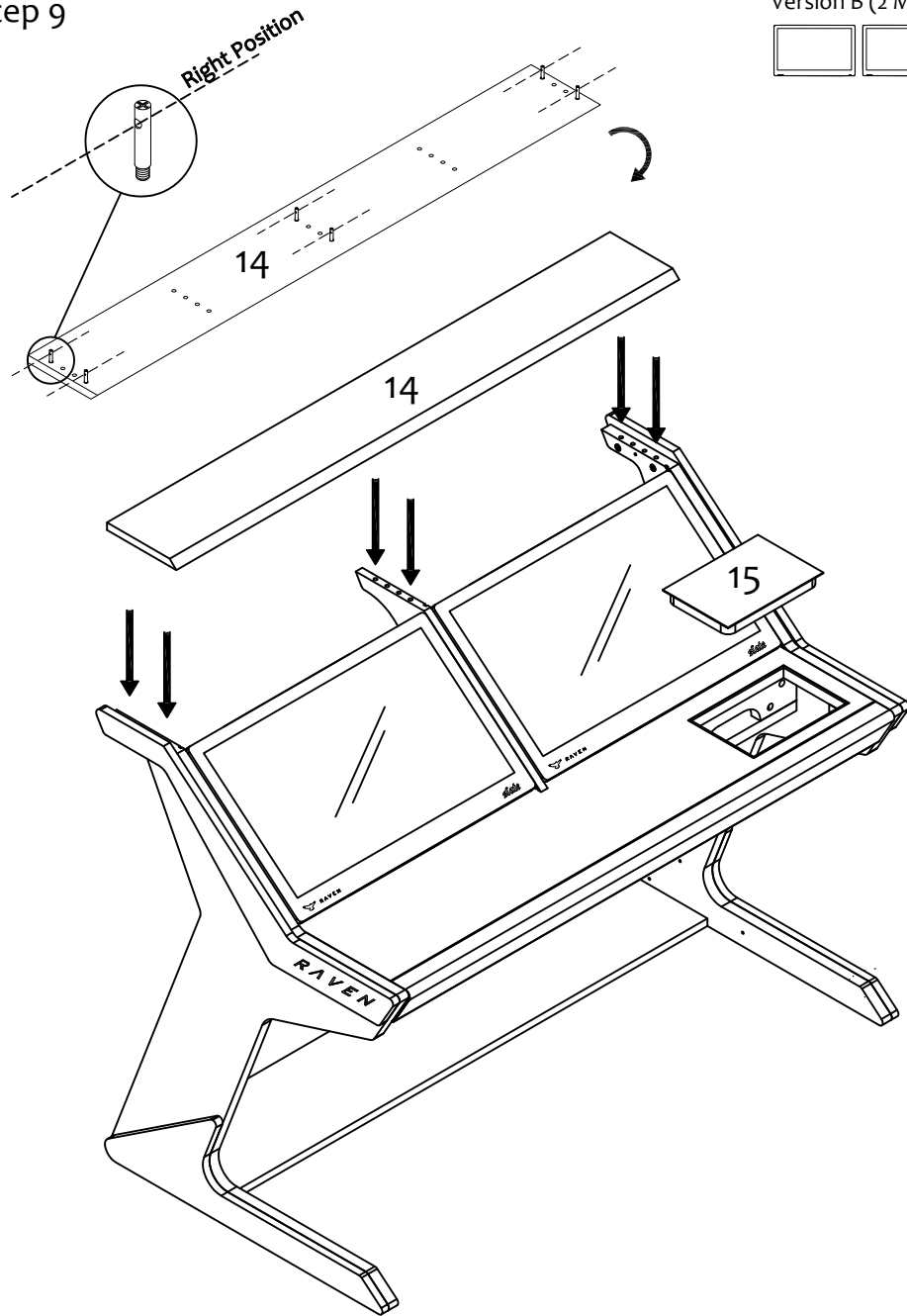

The assembly of your desk uses special kits.

Here's how to use them

- 1) On the piece with the threaded insert(s), put in the system bolt(s) and tighten making sure to align the hole in the system bolt at a 90° angle.

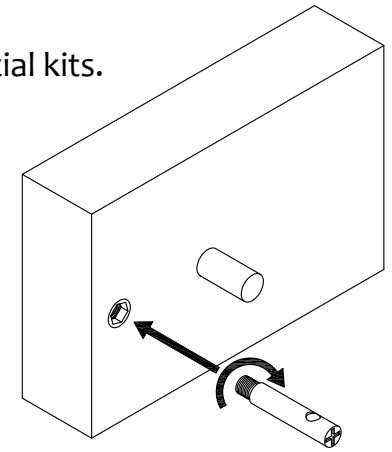

Please note that the system bolt may have a little slack in this position, which is fine!

- 2) Ensure that the hole in the bolt aligns with the opening in the other piece to be able to put in the safety screw.

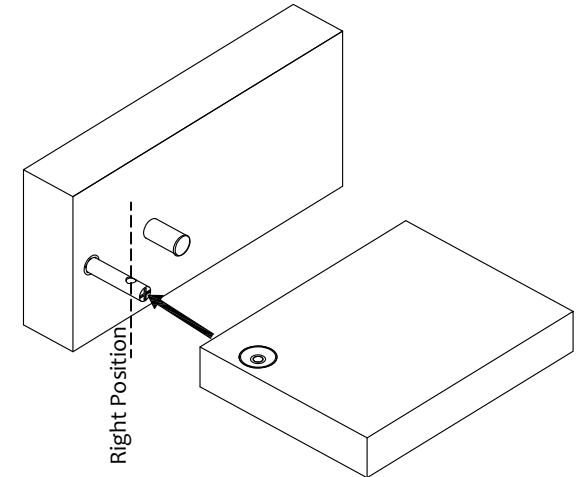

- 3) In each hole in the second piece, put in a cone shaped safety screw and tighten with a cross (philipps) screw driver - without forcing. The 2 parts will now be safely attached.

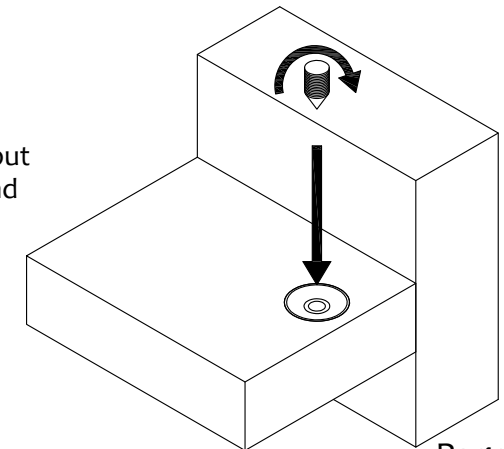

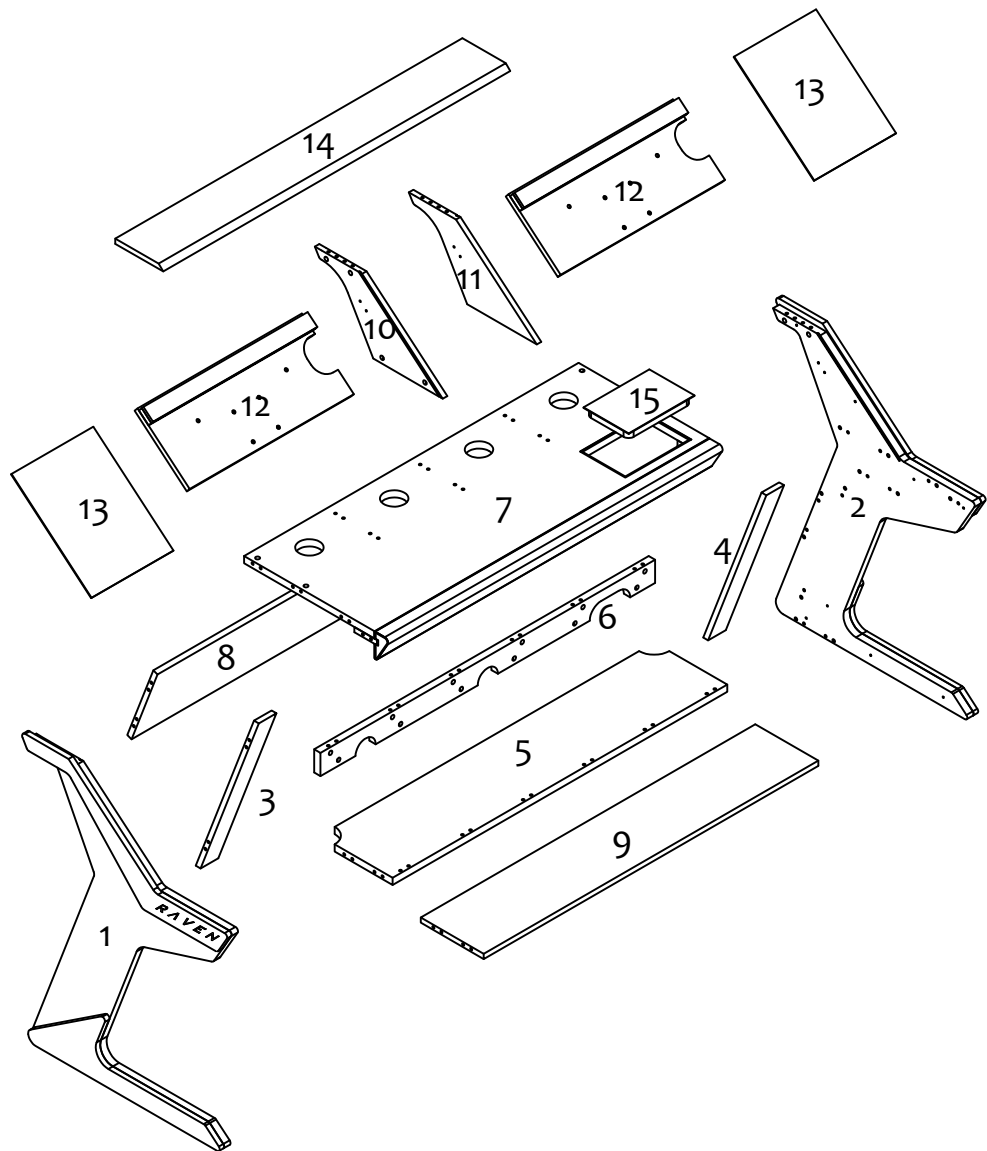

Step 8

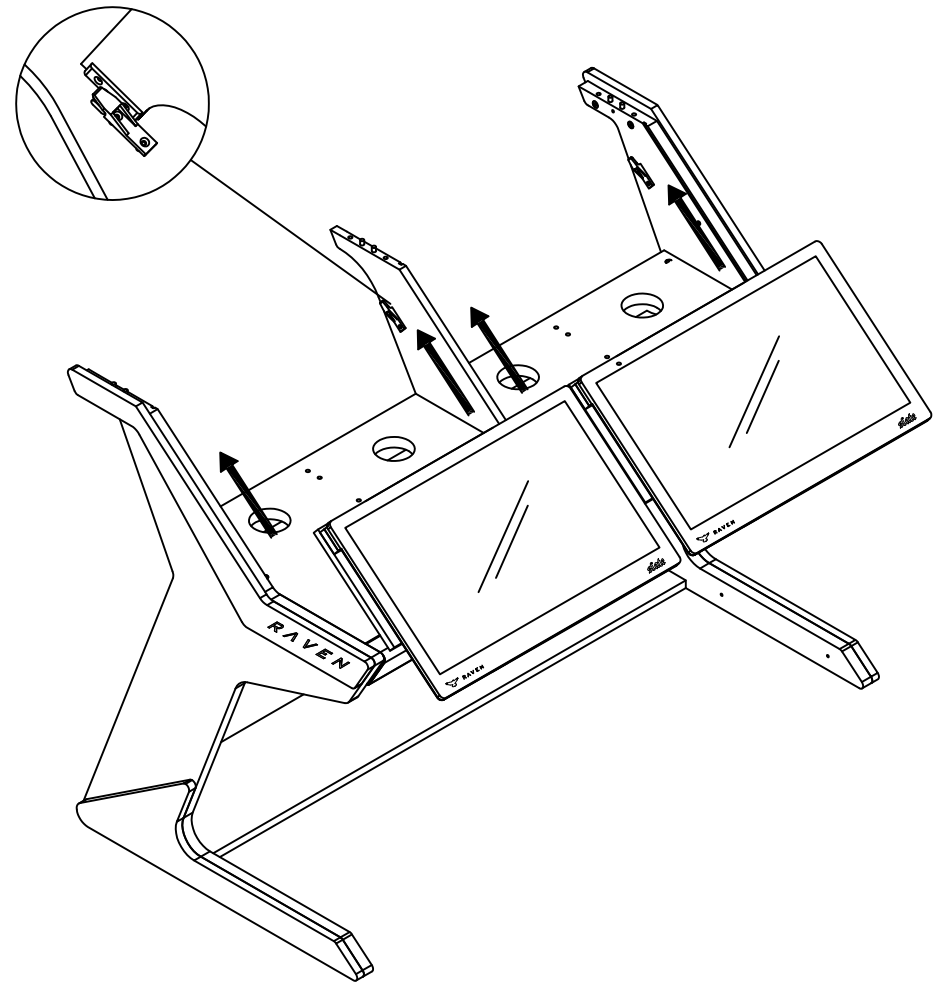
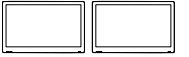

Step 7

Version B (2 MTis)

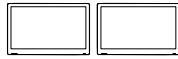

Keku System (Type K)

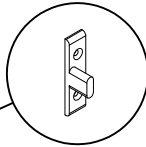

screws (Type S)

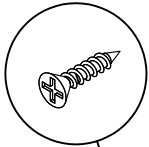

screws (Type V)

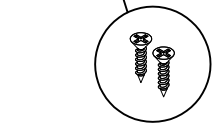
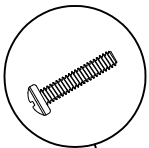

12

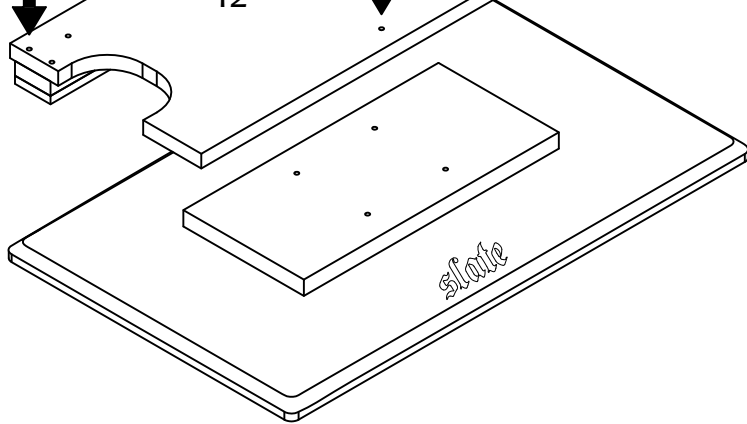

slate

Version A (1 MTi)

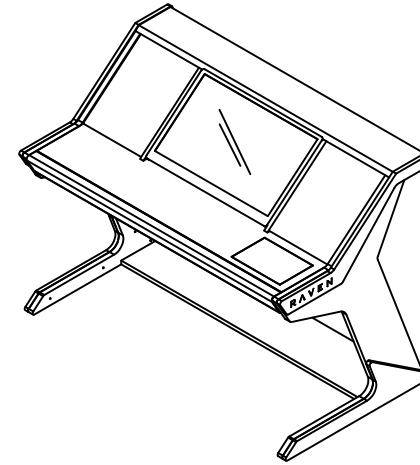
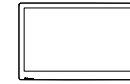

Version B (2 MTis)

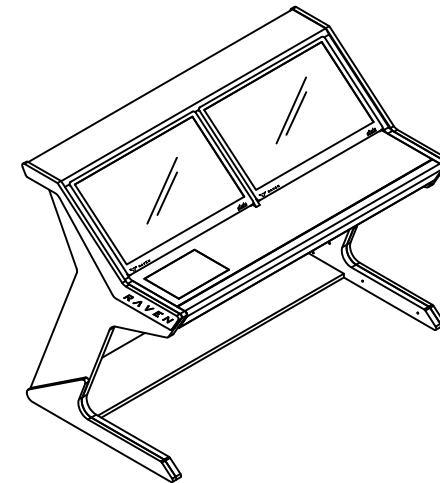

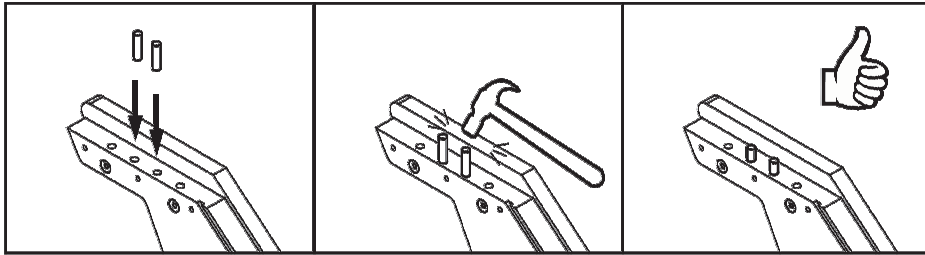

Place the wooden dowels in the indicated holes and with the help of a small hammer push them all the way down (about half the dowel should disappear inside the hole).

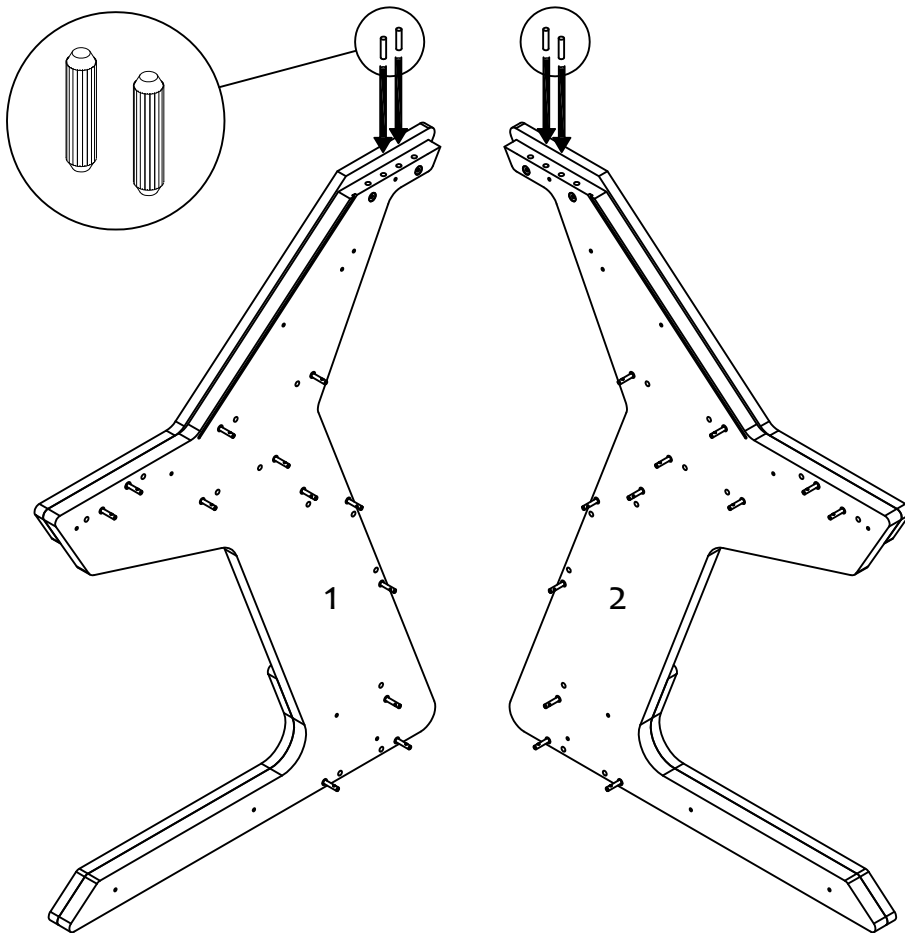

Step 6

Version B (2 MTis)

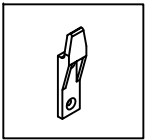

Fix with screws
(Type S)

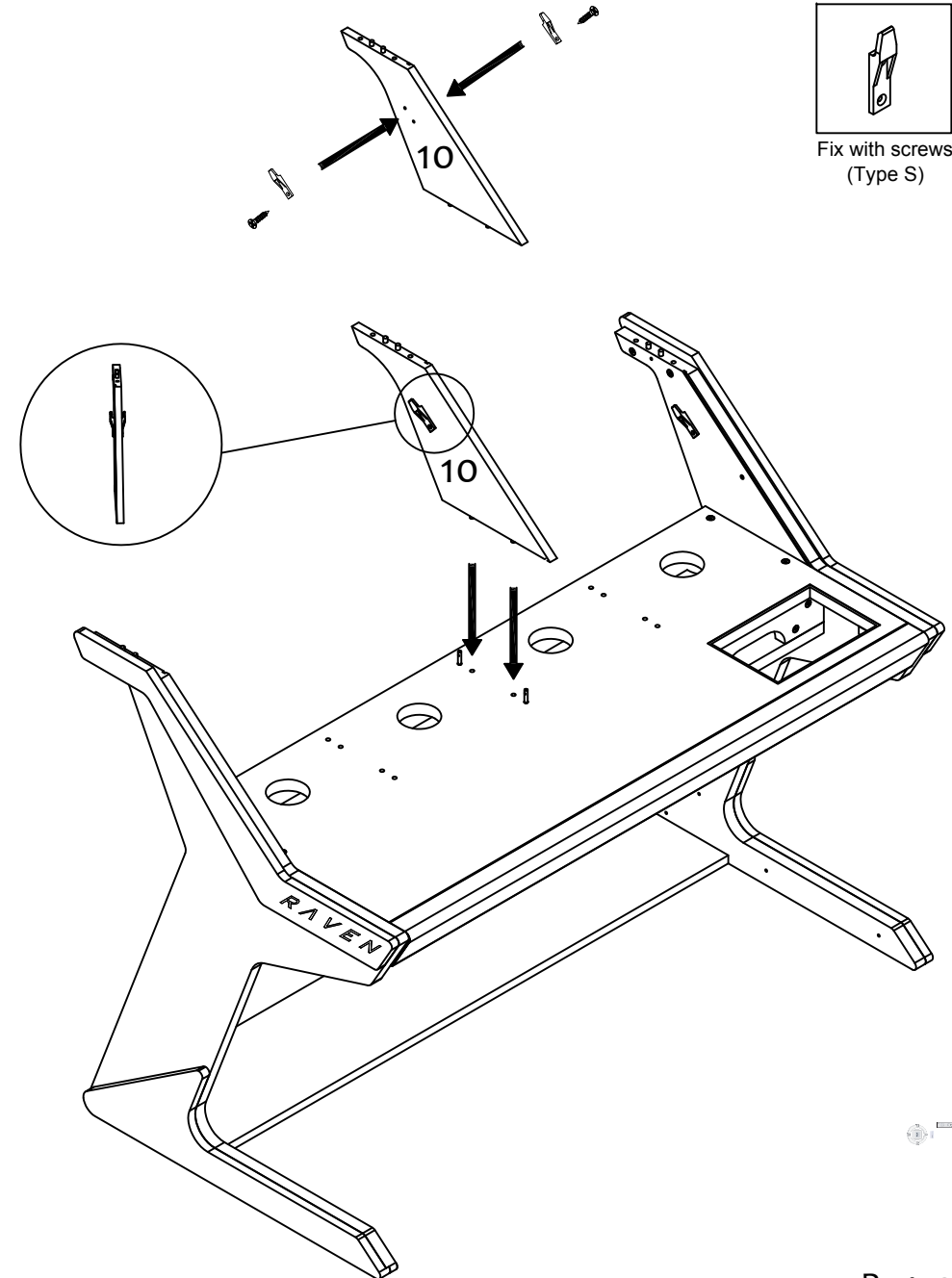

Step 5

Version B (2 MTis)

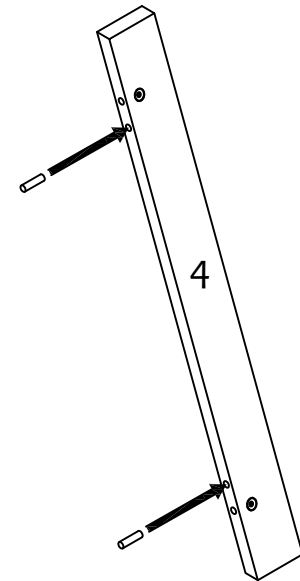
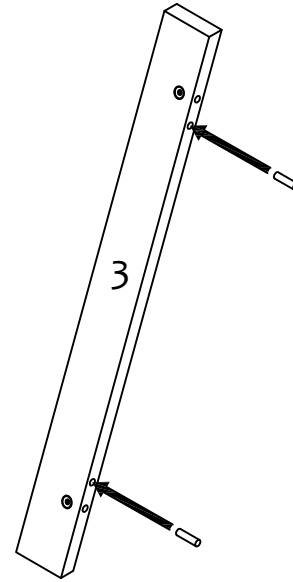
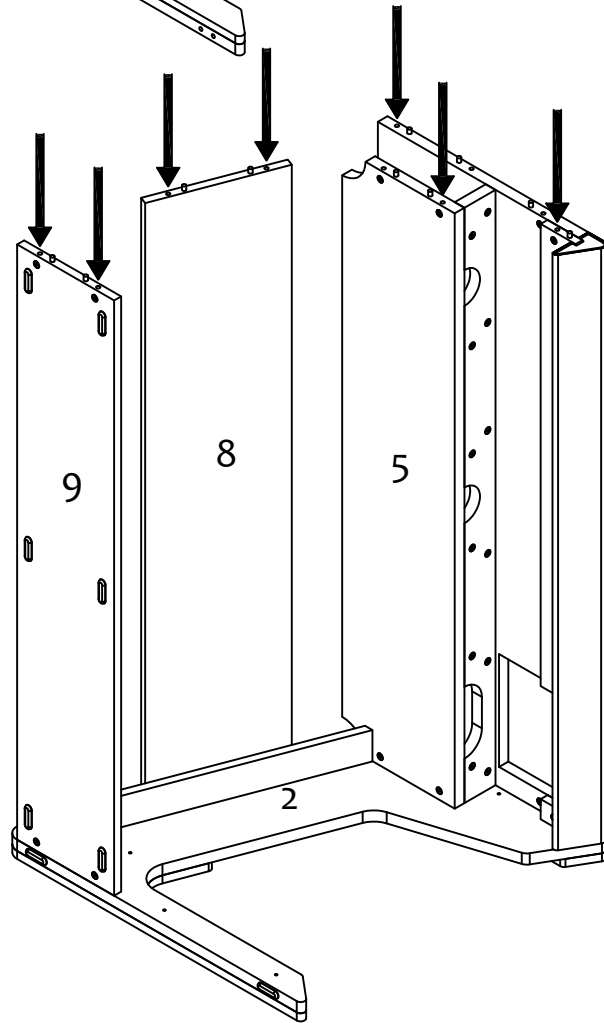
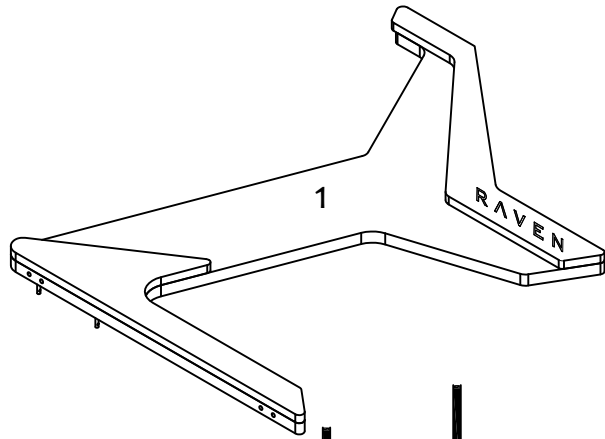

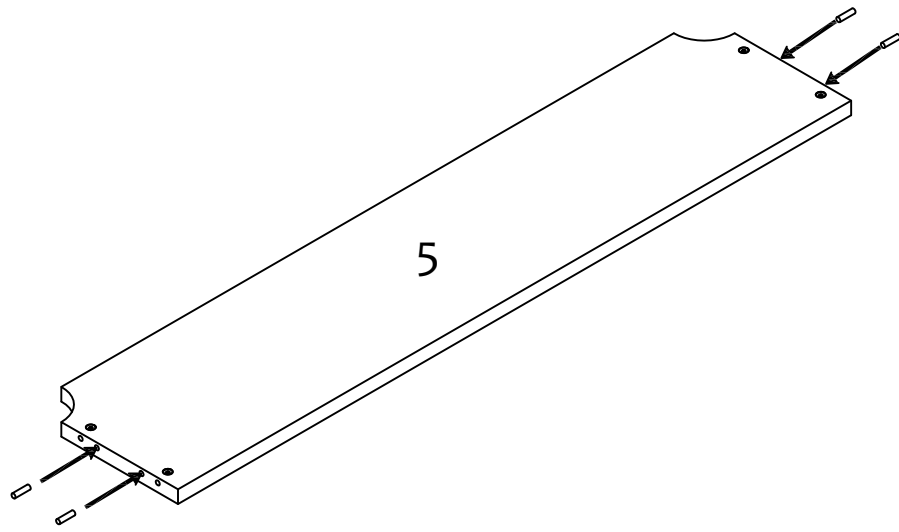

5

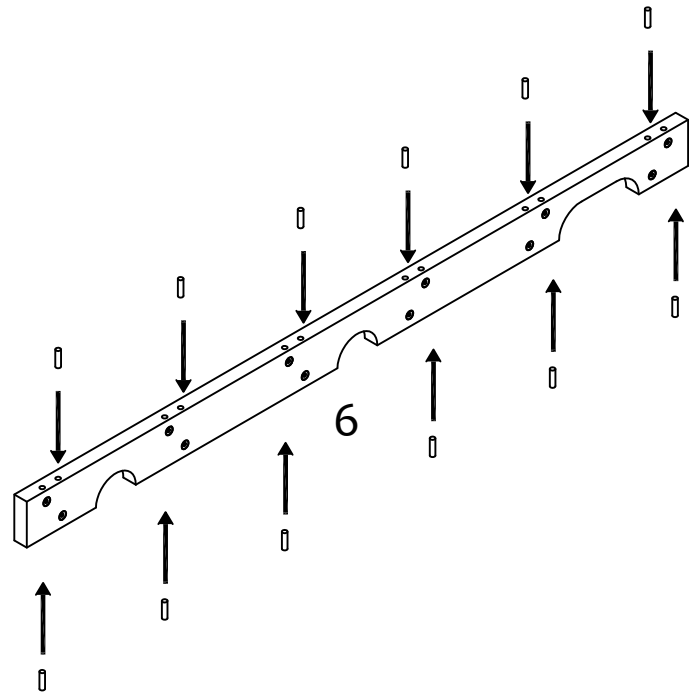

6

Step 4

Version B (2 MTis)

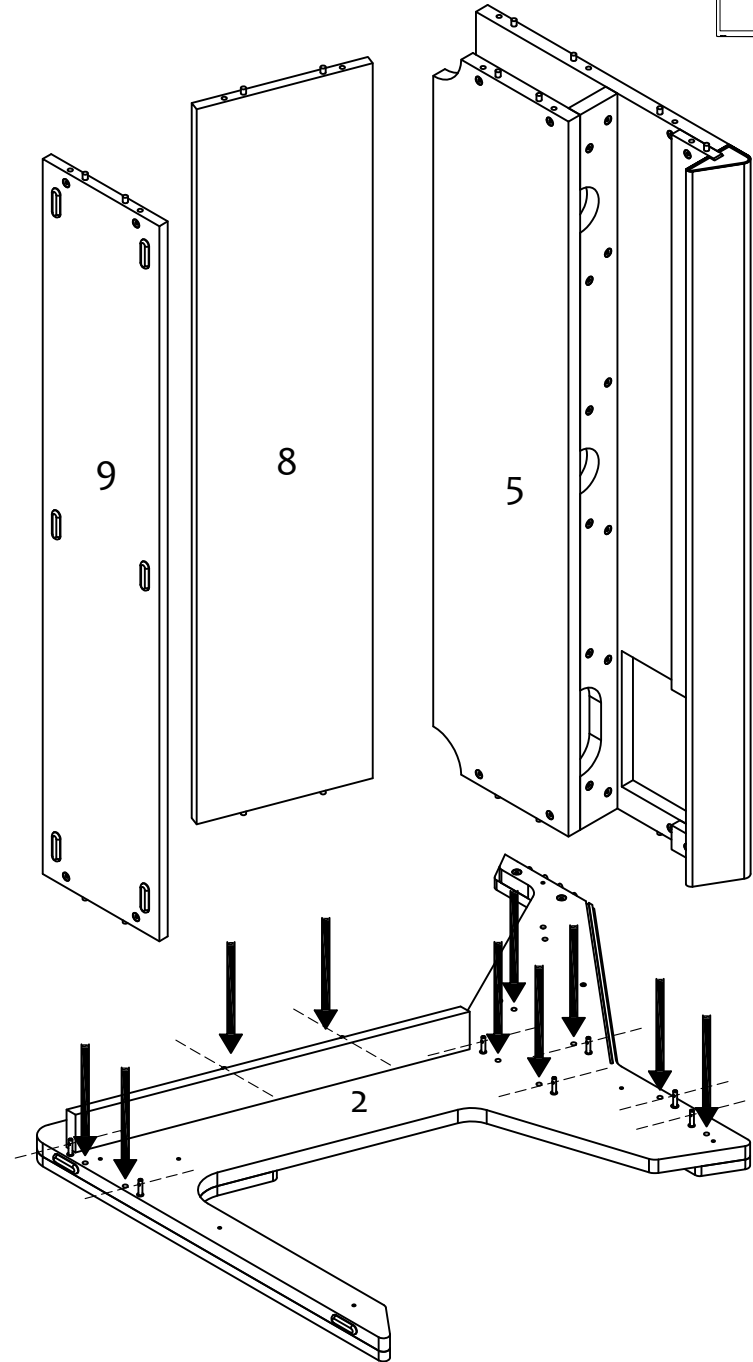
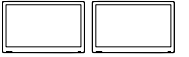

9

8

5

2

Step 3

Version B (2 MTis)

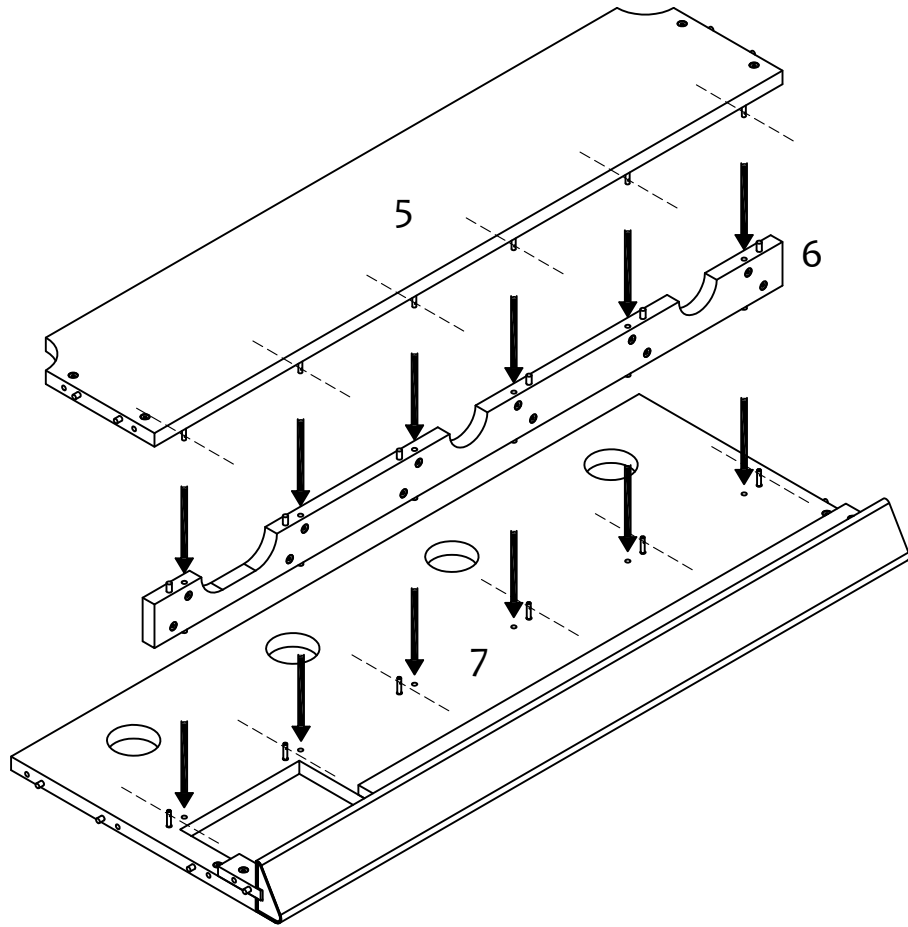

Version A (1 MTi)

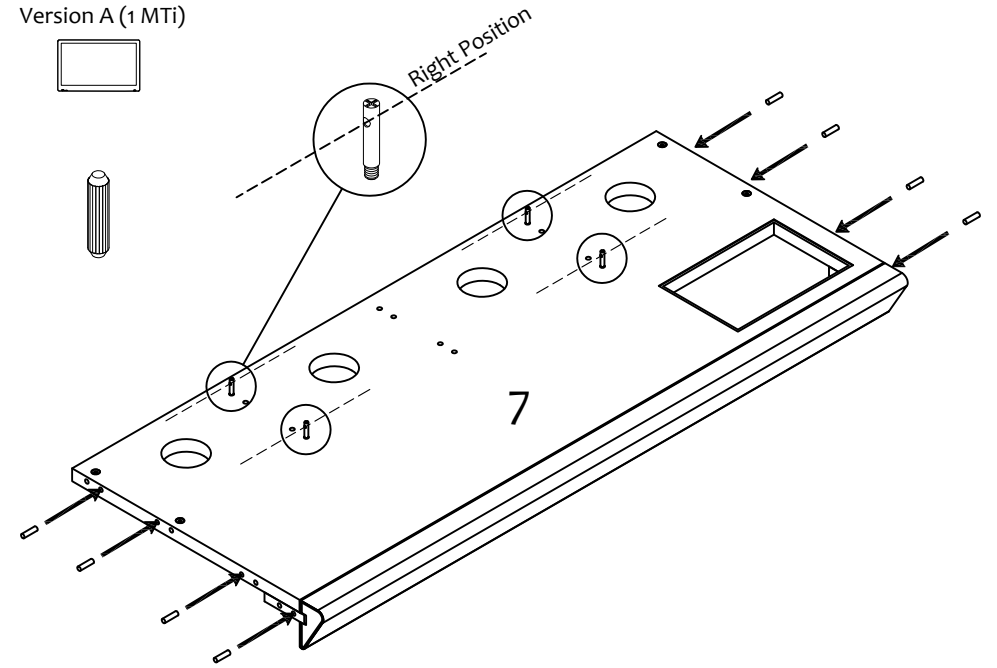

Version B (2 MTis)

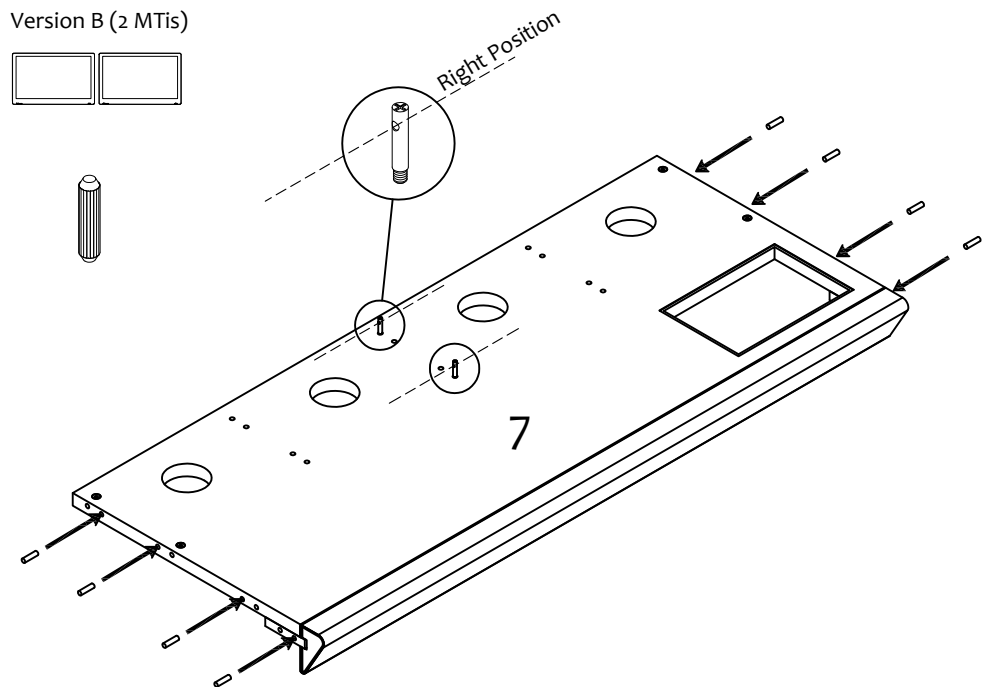
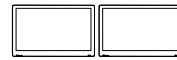

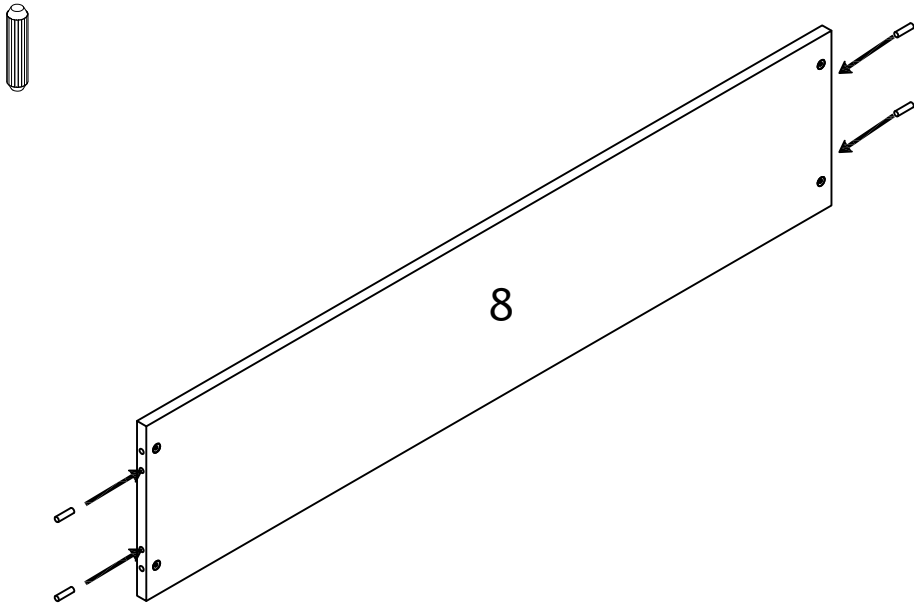

Step 1

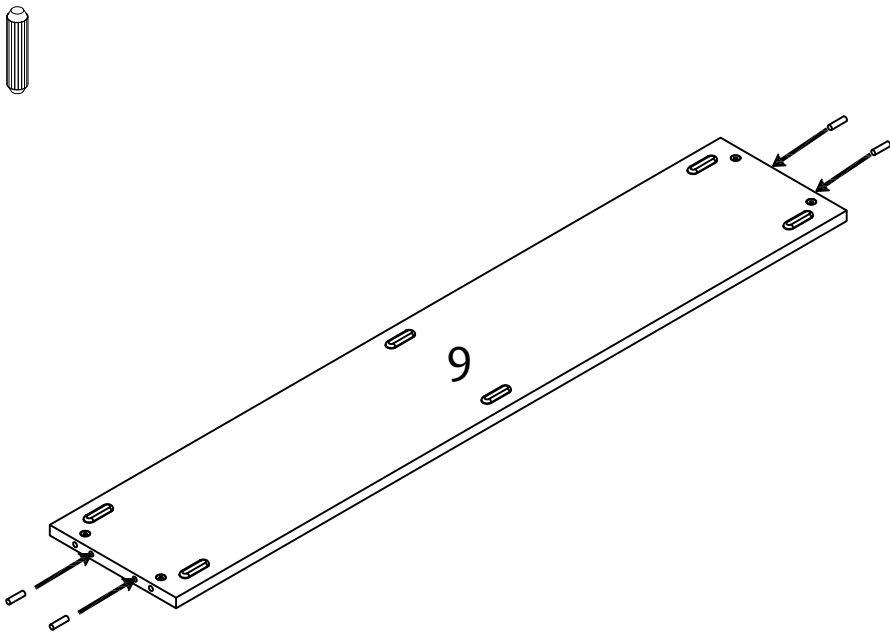
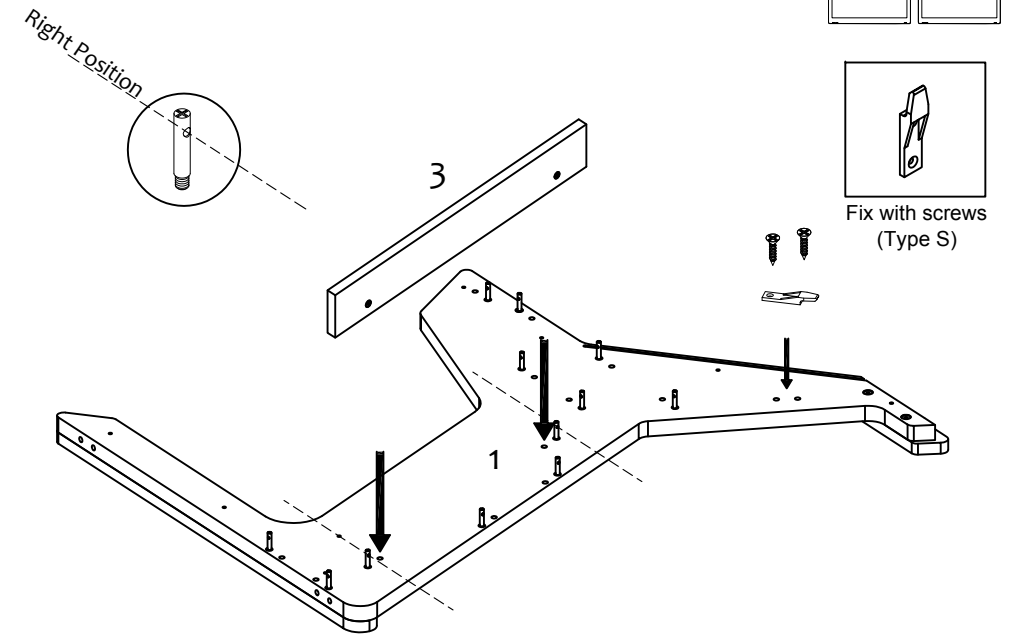

Step 2

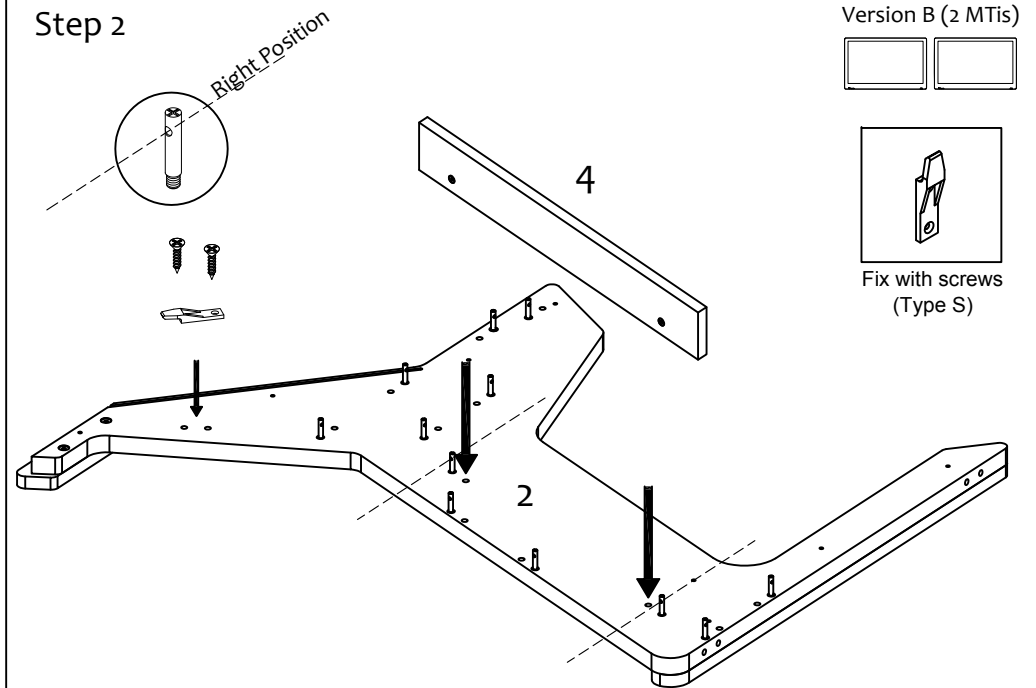

Version B (2 MTis)

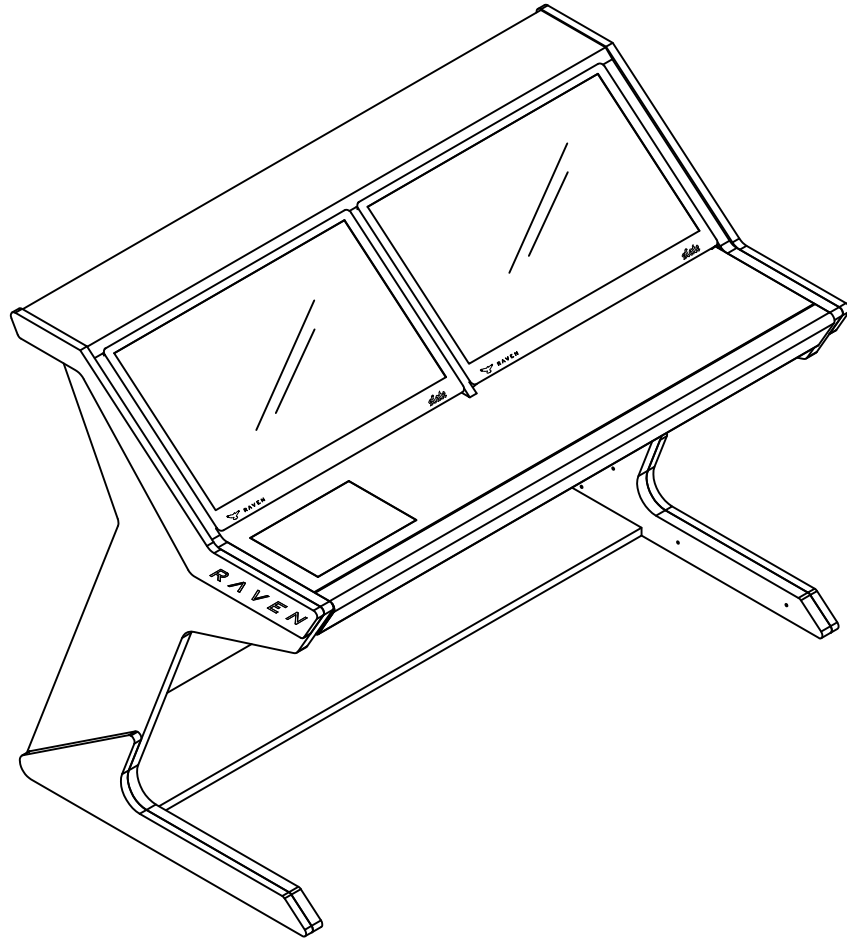
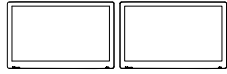

Version A (1 MTi)

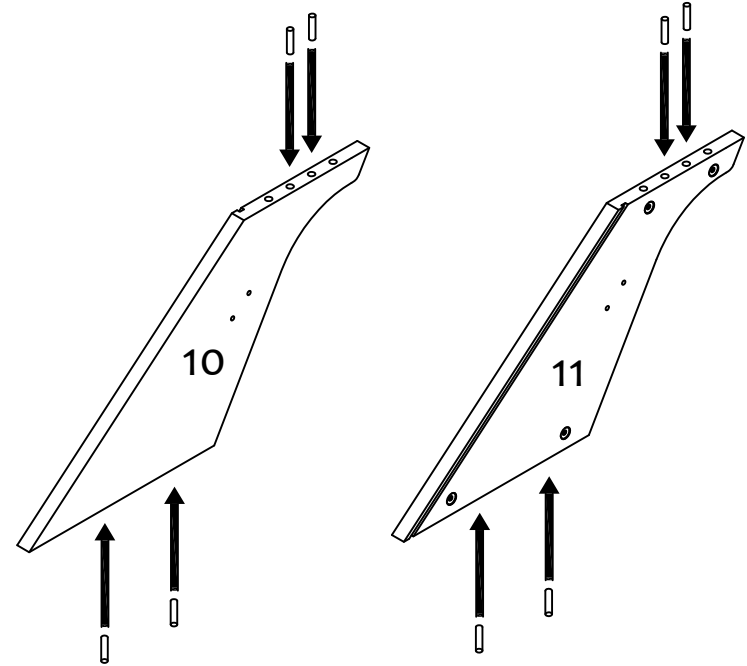

Version B (2 MTis)

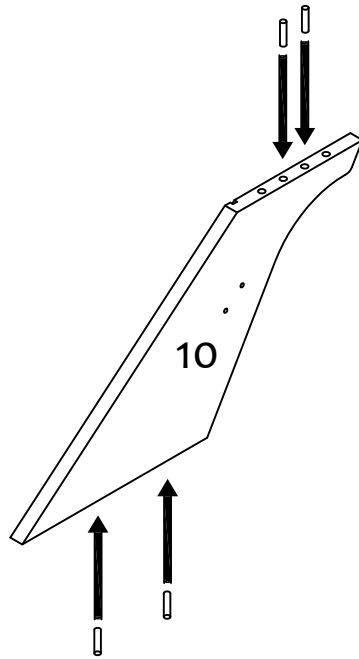

Step 9

Version A (1 MTi)

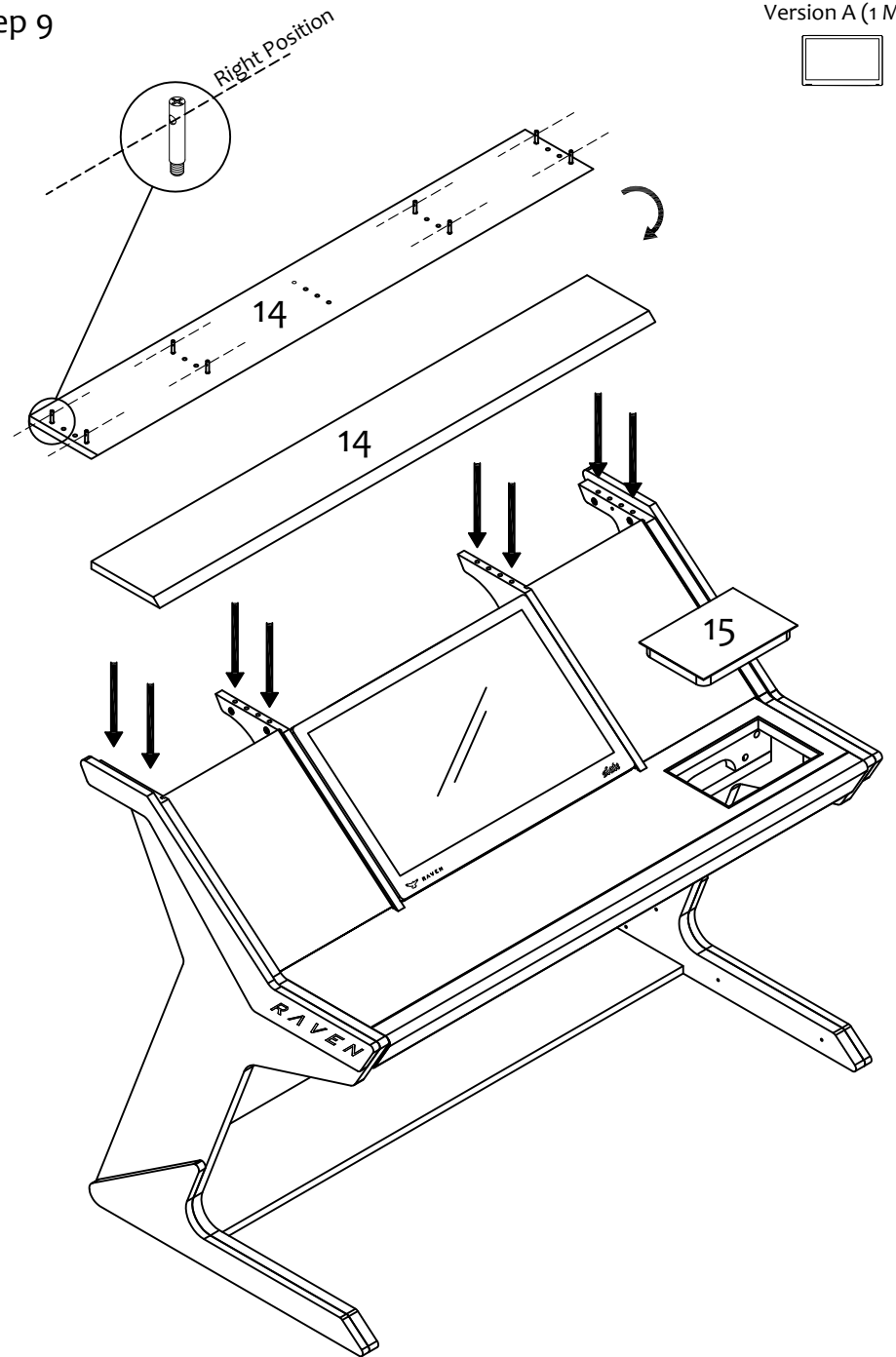

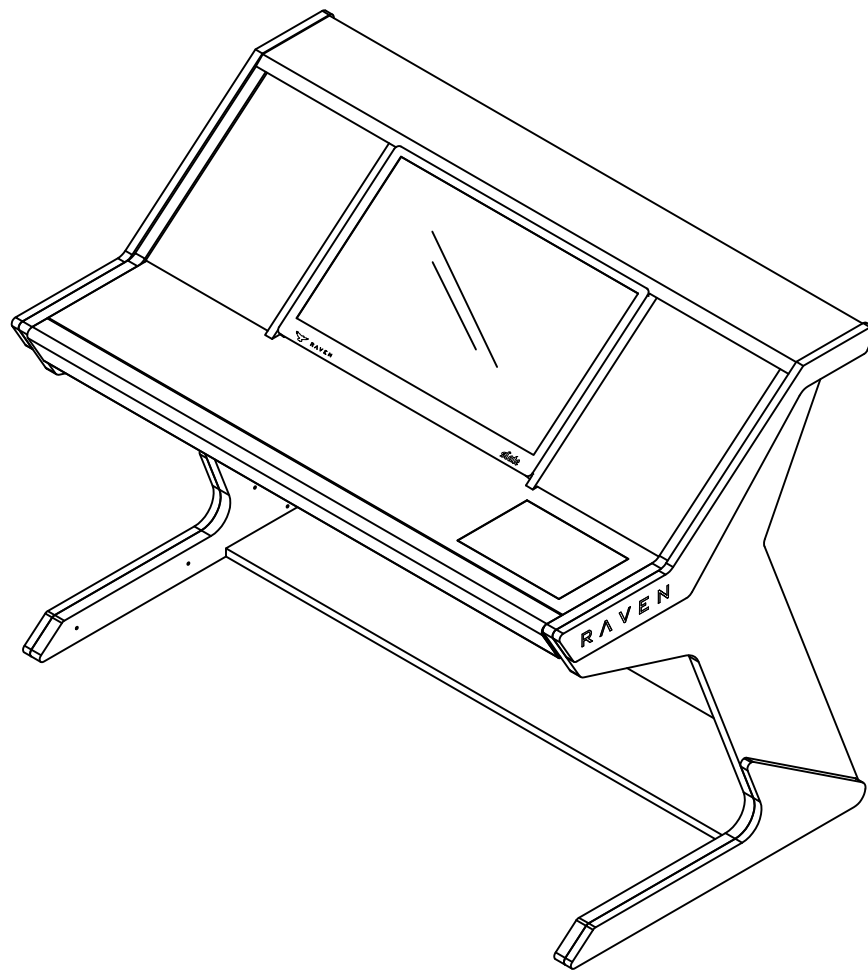
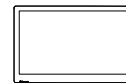
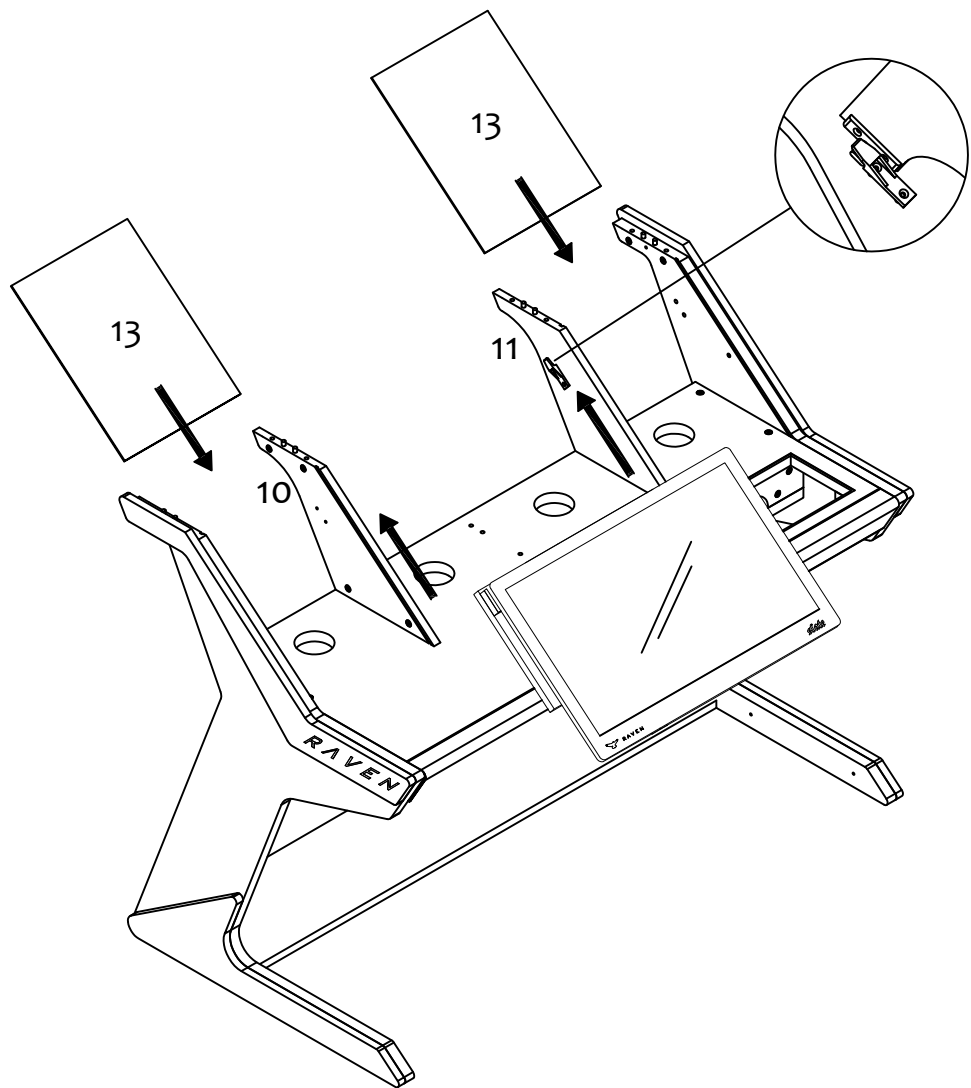

Step 1

Version A (1 MTi)

Right Position

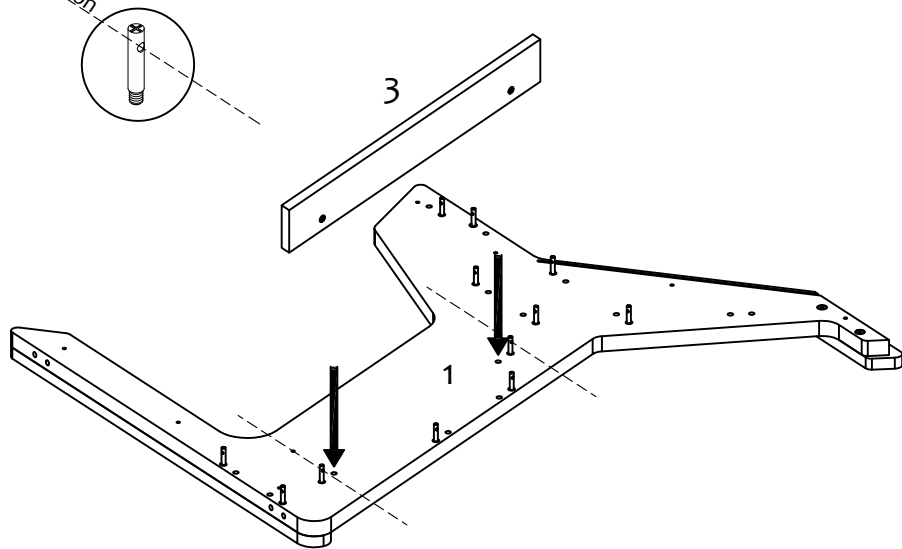

Step 2

Version A (1 MTi)

Right Position

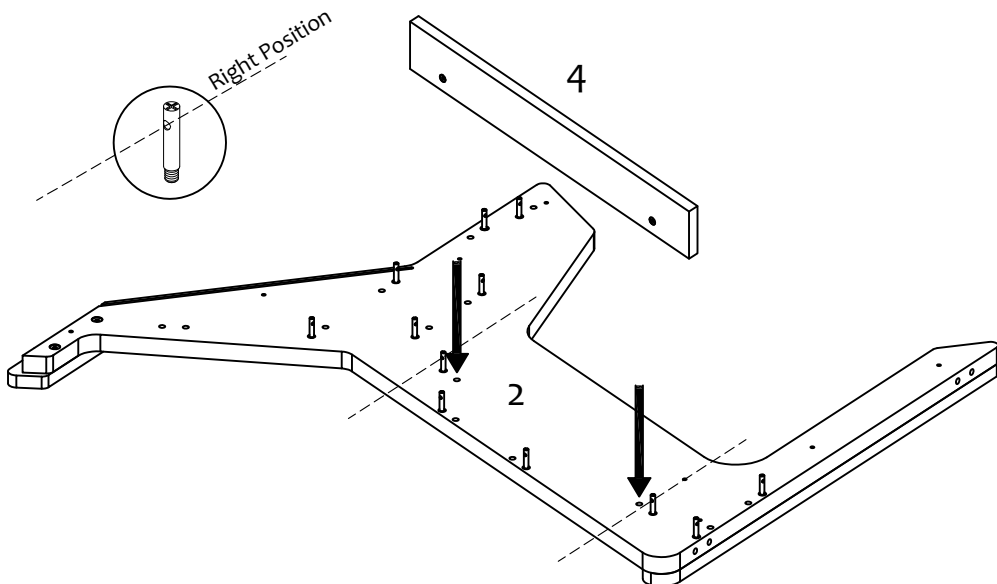

Step 7

Version A (1 MTi)

screws
(Type S)

screws
(Type V)

Keku System
(Type K)

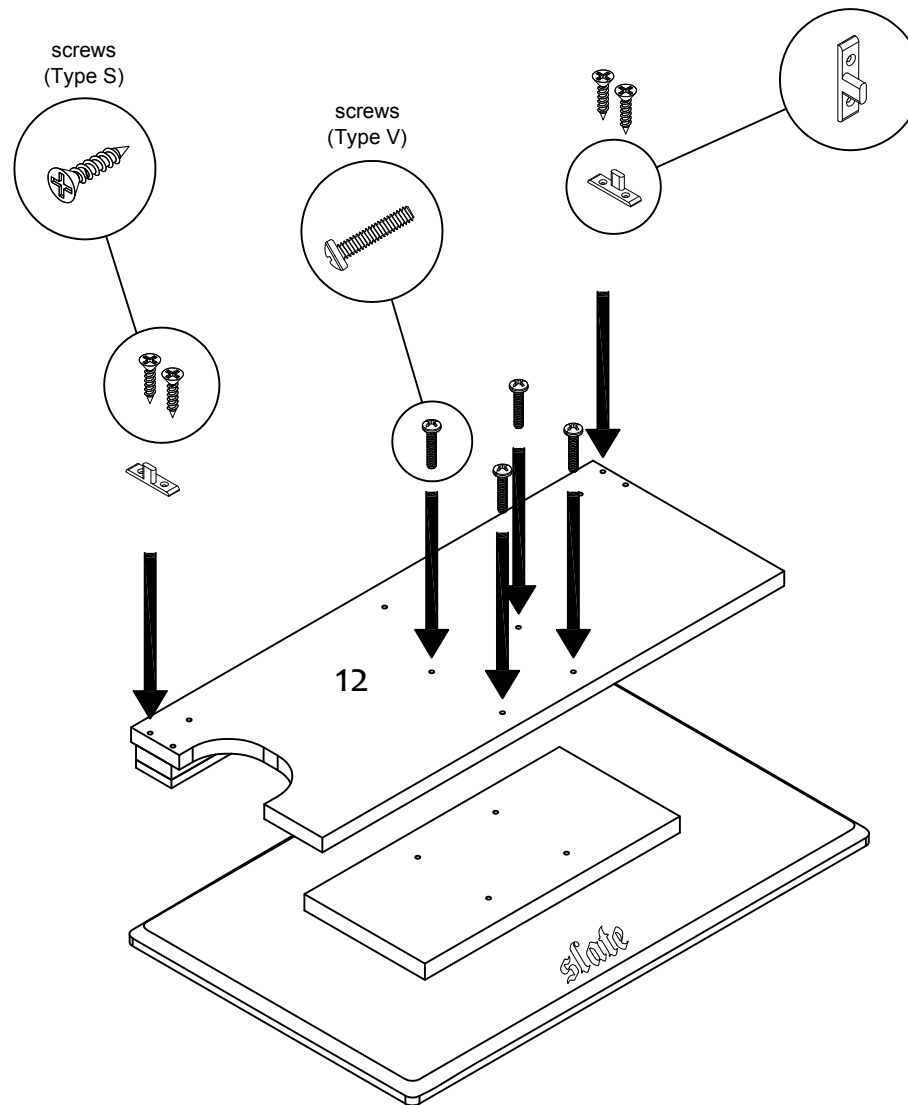

Step 6

Version A (1 MTi)

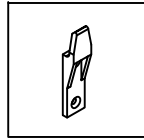

Fix with screws
(Type S)

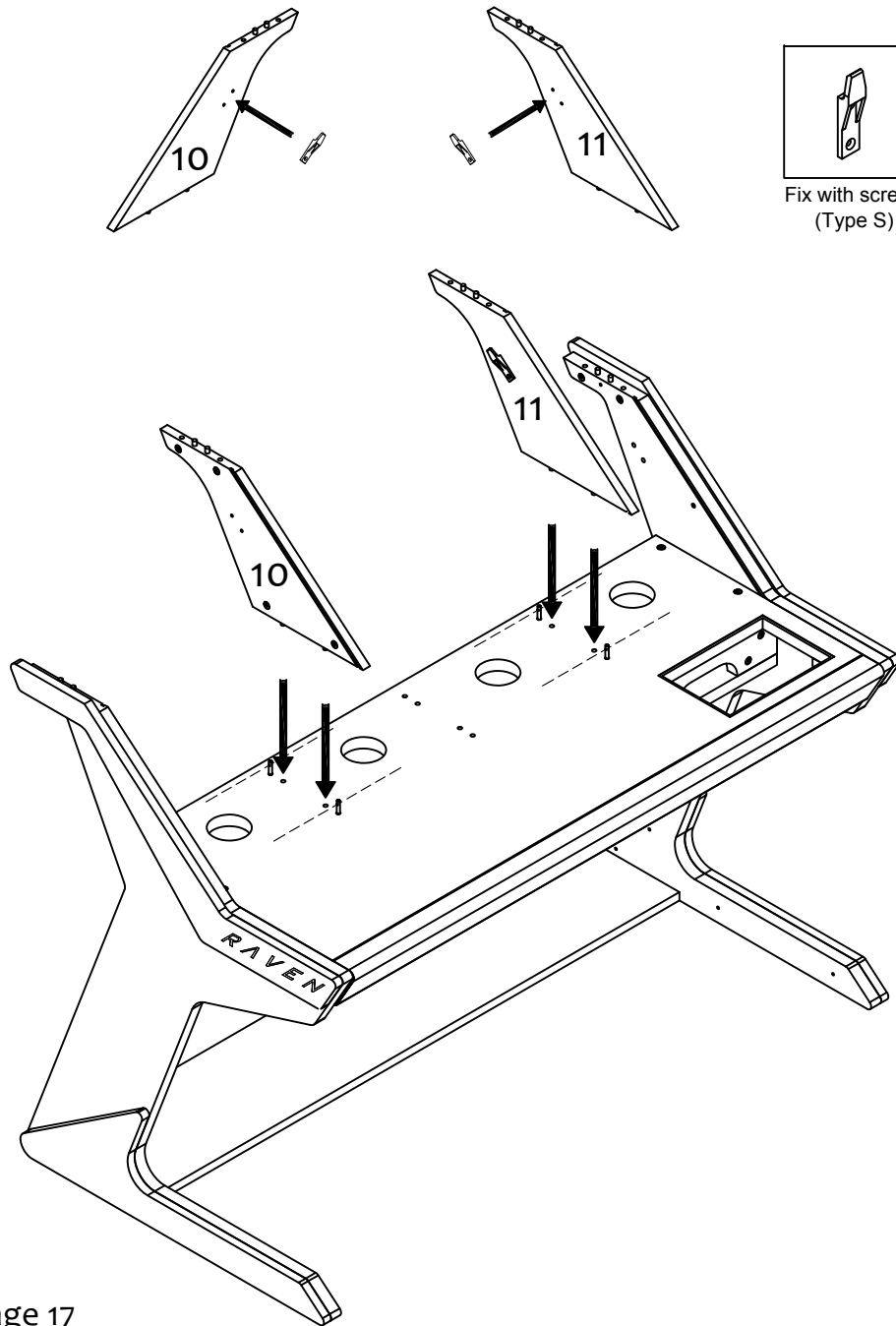

Step 3

Version A (1 MTi)

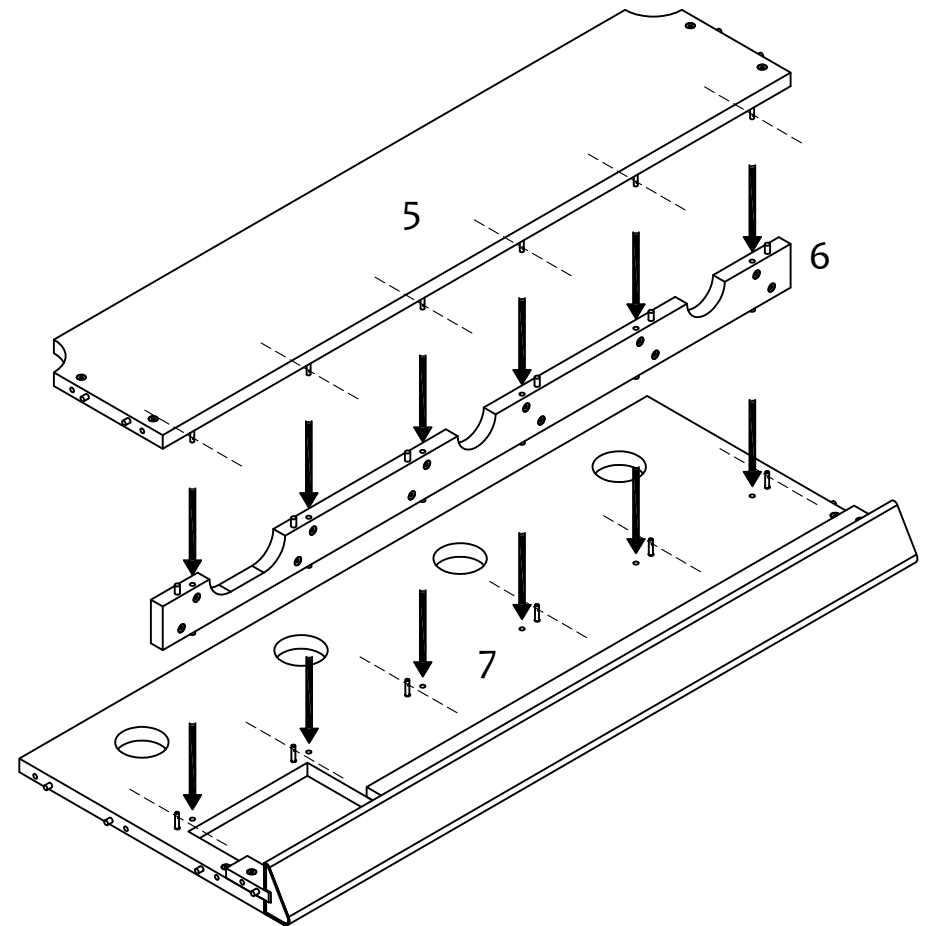

Step 4

Version A (1 MTi)

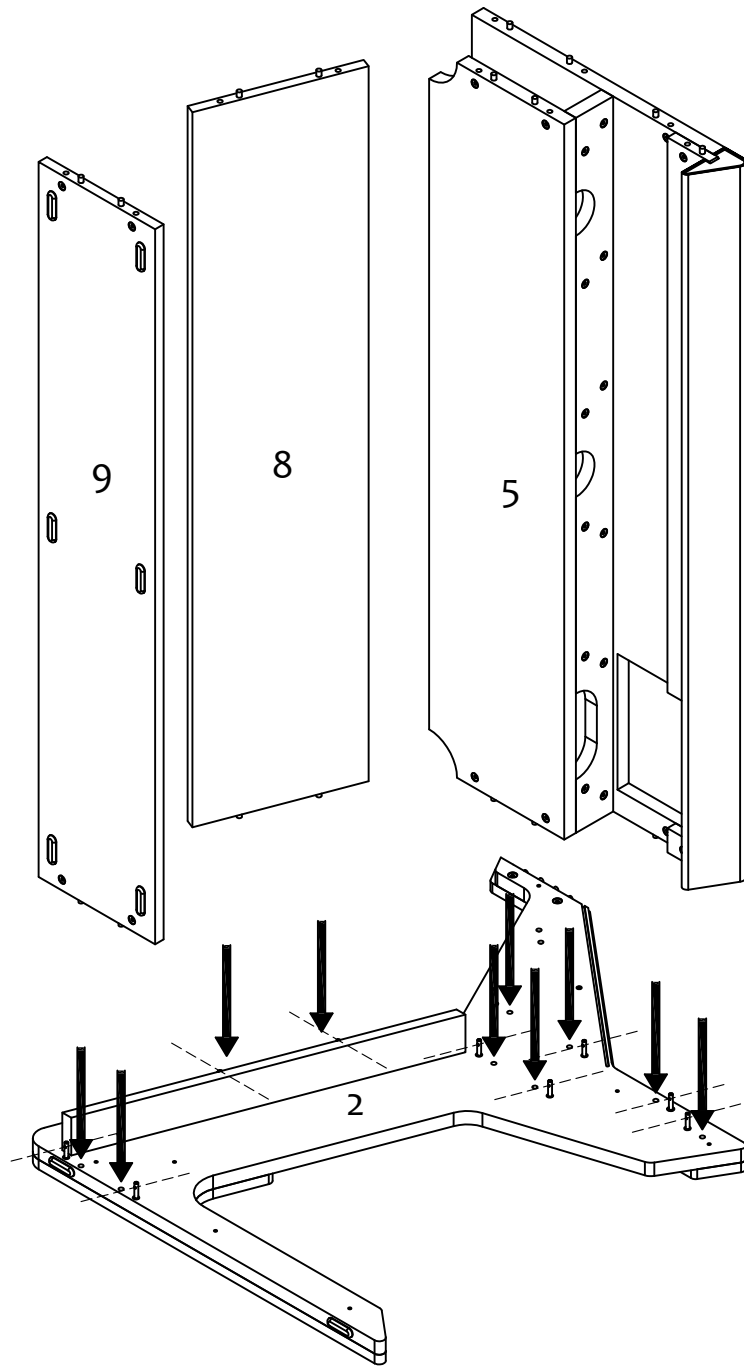

Step 5

Version A (1 MTi)

